

## GENERAL MEETING

Wednesday

February 4, 2015 - 6 pm

South Regional Library

6101 Johnston Street

INFORMAL SOCIAL

See front page highlight!

## LPMGA BOARD

### MEETING

1 PM MONDAY,

FEBRUARY 12, 2015

IRA NELSON HORTICULTURE  
CENTER (INHC)

## WHAT'S INSIDE

- Gerald's Corner
- MG Events, Reports, & Announcements
- Greenhouse helpers needed
- Plant Sale date set April 18
- Festival des Fleurs Mar 28-Mar 29
- What Plant am I?
- Junior Master Gardeners Report
- Jr. MG Camp Apr 6-7
- Garden Stroll Committee
- Bamboo Weekend Feb 27-March 1
- Between the Rows
- February Calendar

### 2015 BOARD: President

Heather Warner-Finley 2012

### Vice President

Linda Beyt 2013

### Recording Secretary

Jay Ruffin, Jr 2012

### Corresponding Secretary

Carolyn Rink 2013

### Treasurer

Sandra Scheuermann 2012

### Board Member at Large

Juan Nieto 2006

### Prior President

Babette Werner 2010

### Agent/Adviser

Gerald Roberts

### Volunteer Coordinator

Mary Ann Armbruster

### Newsletter Editor

Theresa Rohloff

# A Rose is A Rose is A Rose ... A Rose is A Rose is A Rose Happy Valentine's Day



Join Us at our General Meeting—February 4 and learn about  
“Becoming Your Own Landscape Designer”

Megan Montgomery, a licensed Landscape Architect and Master Gardener, class 2014, will speak at South Regional Library at 6 p.m. Megan will teach the basics of drawing our own landscape, using a circle template, engineering scale, and a pencil. If you are interested in drawing along with her, you may purchase these instruments at Louisiana Digital, UL's Student Union Store, or other graphic design stores.

Megan owns Verde Design Studio (<http://verdedesignstudio.org/about-us.html>). She has her bachelor's degree in Landscape Architecture from Texas A&M University, and is a licensed Louisiana Horticulturist. With more than ten years of professional experience in the landscaping industry, Megan has achieved knowledge of commercial and residential planting design and maintenance through practice in Texas, Louisiana and the DC area. The talk is free and the public is welcome.

**Following our business meeting, we will be gathering for a Master Gardeners' Informal Social at Coyote Blues for drinks/dinner. Please email Linda Beyt ([lbeyt@att.net](mailto:lbeyt@att.net)) or call her (278-1258) by February 2 so she can let the restaurant know how many to expect!!! Plan to have a little fun!**

## PRESIDENT'S MESSAGE



**Heather Finley**

I write this message in mid-January, just as the gray dreary winter days following New Years have passed, and the air is clear and warm. It's a harbinger of spring and of renewal. With that in mind, I want to discuss the action items that came out of the LPMGA Executive Board Retreat.

We had a spirited and open discussion about some issues that face our organization, and resolved upon 3 critical action items for 2015. This month, I'll address the first: **Identifying relocation options for LPMGA.**

We all know that at some point, ULL will move the Horticulture Center elsewhere to make room for University Research Park developments. We don't know when that will happen, and that's been a source of unease for many of us. We feel like the proverbial feathers in the wind – critically affected by and yet having no control over the university's decision. We can,

however, investigate possible future “homes” for the LPMGA, including the Park at the Horse Farm. The board feels that understanding our options will improve our decision-making ability and help us understand the possible costs of making that move and still preserving our ability to have master gardener classes, propagate plants for sales, and provide demo and other teaching beds to educate the public about various aspects of horticulture. Babette Werner, our Past President has agreed to chair an *ad hoc* committee to do just that. She announced at the January general meeting that she welcomes members who want to participate in the investigations as well as suggestions from the membership regarding possible locations. I've seen some very good ideas come in via email, and I hope and expect that the membership will have a lively discussion about these options in the months to come. I invite every single Master Gardener to participate.

Also speaking of spring, let's not forget that Festival des Fleurs is on the horizon. The festival will be held on 28-29 March 2015. Please support the Ira Nelson Horticultural Center by volunteering your time (and shopping, of course). Contact Sharon Bakay for volunteer information. Thanks.

Heather

## GERALD'S CORNER

Master Gardeners make important and valuable contributions to their community by working as volunteers through their parish LSU AgCenter Extension Service Offices. I'm always asked by people what type of people does it take to be effective as a Master Gardener. My answer is generally the same and that is it takes someone who genuinely want to learn, someone with a willingness and desire to help others, and someone who is willing to commit to assisting the LSU AgCenter in educating their community by delivering horticulture information; however, whether it be the willingness to learn, the willingness to help others, or the willingness to assist the LSU AgCenter it takes COMMITMENT!!! Just as the LSU AgCenter tries to honor its commitment to provide the most effective educational experience to Master Gardeners in Training, it is expected that when you sign up to become a Master Gardener that you not only honor your commitment to meet the requirements of the Master Gardener Class, but also to honor your commitment to complete your volunteer hours. I would go a step further and ask that each new Master Gardener look for an opportunity within LPMGA to get involved as a means of not only to continue to grow and learn but also to help the LPMGA in meeting its commitment to assist the LSU AgCenter in meeting its mission. We need everyone to make this work!! While we do our best not to be too aggressive in making things mandatory, we hope that you place confidence in our dynamic Master Gardener Association by doing your part to make it work. I've always said that when everyone is willing to do just a little for the greater good, it makes everybody's effort just a little bit easier. I reach out to each of you individually and to our Master Gardener Group, collectively, and I ask that you make a special effort to become involved to a greater extent if you're not already involved. Also as you spread the word about the Master Gardener Program and answer questions about the program, please emphasize to potential Master Gardeners that once they become certified Master Gardeners, their time and talents are very much needed. I think we all want to continue to grow in the area of horticulture and what better avenue to grow than to find experiences within LPMGA to facilitate that growth.

That brings me to another avenue that will create not only opportunity for your personal growth, but also enhance your opportunity as a Master Gardener to help educate others and also assist me with the high volume of horticulture calls that come into the Extension Office from our community. It would also give Master Gardener another option to add to or complete their volunteer hours. I consulted with Mr. Miles Brashier who is currently serving as the LSU AgCenter's State Master Gardener Program Coordinator and he feels this procedure creates a good situation for everyone involved: Master Gardeners, people in the community with horticulture interest, and the LSU AgCenter. In the past I was asked by several Master Gardeners that we create an opportunity for Master Gardeners to connect with the Extension Office and an opportunity for those that would be interested in coming into the Extension Office to take horticulture-related calls. While we're still working on the details, it will be strictly voluntary, it will be as simple as possible, and you will not be left on an island without support. Even though it can be very intimidating – especially with requests for information that you may not be familiar with – you will have the option of telling the caller that you'll call them back (if you'd like time to do some research) or you will refer the call to the LSU AgCenter Horticulture Agent. At the general membership meeting in February, I plan to make a brief report regarding the details of how the process will work and answer any questions. I have already met with the LPMGA's Executive Board, so everyone will be on the same page. I plan to follow up on my initial discussion with Mr. Brashier for his input so that we provide the best results for you or the AgCenter. As I told you'll at the January general meeting, I'm excited as we begin a new year and I am looking forward to a very productive year that will continue to enhance the credibility of LPMGA !!!

As you know, the optimum time for transplanting trees and shrubs here in South Louisiana is late Fall through Winter. February is the last optimum month for transplanting trees and shrubs in our area. When we use the word "optimum," we mean that time frame that enhances a plant's ability to survive, become established, and reach its productive potential. The reason why we emphasize the dormant period is because trees and shrubs transplanted during their dormancy experience less transplanting shock, which greatly enhances its chances of survival. It allows the root system to begin expanding and become established, which helps it to survive a hot, and sometimes dry, first summer following its transplant.

The second issue relates to the actual task of transplanting. First, select a well-drained area that is also going to provide the sunlight requirements of the plant. The second planting hole itself which if not done properly can lead to rot problems because of our soil type, high water table, and the poor internal drainage that exists in some areas. Everything can be done right in terms of selecting the right plant, placing it on the right site, and transplanting it correctly; but if the drainage is poor – especially during periods of heavy rainfall – water standing around the root system will greatly affect the plant's ability to survive because of high susceptibility to root rot. One of the main reasons I see contributing to poor plant performance is planting depth or planting too deep. When placing the plant in the transplant hole, the top of the root ball should be even with the surrounding soil or the existing grade. Anytime the top of the root ball falls below the surface of the surrounding soil, there are potential problems. The width of the transplanting hole should be twice the width of the root ball.

Finally, only the existing soil should go back in the hole as a backfill once the plant is in the hole. It is no longer recommended that soil amendments be added to existing soil. Research indicates that the root system may be reluctant to expand beyond amended soil which could delay its establishment.

HAPPY GARDENING!

**Gerald P. Roberts**

Horticulturist/Master Gardener Program Coordinator LSU AgCenter

1010 Lafayette Street, Suite 325, Lafayette, LA 70501, GRoberts@agcenter.lsu.edu, Office (337) 291-7090 / Fax (337) 291-7099

## EVENTS, REPORTS, AND BOARD ANNOUNCEMENTS

EMBRACE THE CHALLENGE

BRING YOUR REUSABLE WATER BOTTLE TO MASTER GARDENER FUNCTIONS!

## LPMGA SPRING PLANT SALE &amp; PLANT SWAP

SATURDAY, APRIL 18<sup>TH</sup> 10am at the Demo Beds*It's not too early to start those cuttings for the Spring Swap!*

The Spring Plant Swap and Sale has been scheduled as the April 18<sup>th</sup> Garden Talk, 10am in our Demo Beds at the Ira Nelson Horticulture Center.

Bring one rooted and identified plant for the formal Swap, some to trade before and after the Swap, and any "extras" you have (especially foundation plants) to be collected for Habitat For Humanity.

Also, bring along extra seed packets you might have, or seeds that you have collected (please label them), and we'll have a Seed Exchange.

Contact Louann Long at [mglouann@gmail.com](mailto:mglouann@gmail.com) if you need more information, have questions, or would like to volunteer to help at the Swaps.

2015 LPMGA Meetings:  
(First Wednesday  
Except in January & July)  
Daytime—noon/Evening—6 pm

2015 LPMGA Board  
Meetings, 1 pm:  
(Third Monday except for  
Jan., Feb., Jul. & Dec.)

FEBRUARY 4—South  
Regional Library, 6pm

FEBRUARY 9—INHC, 1 pm

MARCH 4

MARCH 16

APRIL 1

APRIL 20

MAY 6

MAY 18

JUNE 3

JUNE 15

JULY—NO MEETING

JULY—NO MEETING

AUGUST 5

AUGUST 17

SEPTEMBER 2

SEPTEMBER 21

OCTOBER 7

OCTOBER 19

NOVEMBER 4

NOVEMBER 16

DECEMBER 2 Social

DECEMBER 14

## 2nd Saturday Class Canceled



The Second Saturday Gardening Class for February 14 will be canceled due to a Mardi Gras Parade in Youngsville, which will block access to and from the site.

Green T Lindon is also undergoing a major expansion and renovation, thus an alternate site may be necessary for the next few months.

For Festival des Fleurs info, contact Colette Anzalone 337-288-0283



Save the Date

Saturday & Sunday  
March 28-29, 2015  
Blackham Coliseum

## NOTE FROM JUAN NIETO:

Hello Master Gardeners,

I want to begin by saying, thank you for allowing me to serve as your member at large. It is truly an honor to serve you. I am making myself more available to you by joining the hard-working propagation committee on Wednesdays.

Many of you are aware that the propagation committee has been struggling with our greenhouse. It is in need of some TLC. The board has set some money aside for this purpose.

We requested a bid from one of the glass companies; however the bid was too high for so little work. I have posted this information at the cottage. The bottom line is that we can do most of the work ourselves. I can take care of the more difficult tasks; however, I will need some help with some of the ground work, and some of the work will have to wait until after April 18, which as you see above is our Spring Plant Sale. Some fellow gardeners have suggested that we set a "Greenhouse Work Day" after the Plant Sale on April 18.

There is some work, though, that we can do right away. Those of you who have not yet signed up to serve on a committee, I urge you to consider helping out. My hope is that we do not disrupt the work of the propagation committee, by working around them. If you have any suggestion or comments on the greenhouse and the repairs, please feel to let me know either on Wednesdays at propagation or by e-mail.

I look forward to serving you this year, and I thank all the many volunteers that have signed up with our many committees.



Your Member at Large  
Juan Nieto  
(337) 290-1451  
[jfnieto1@netzero.net](mailto:jfnieto1@netzero.net)



## GET THE NEW CALENDAR!

If you don't have one of the new LSU AgCenter's 2015 Get It Growing calendars, what's the problem? There are members kicking themselves having missed the January kickoff with calendar tips. Get it together and get your calendar now! Surprise your Valentine with a calendar to keep up with the times and special dates **LIKE FESTIVAL DES FLEURS! MARCH 28-29!!** 🌞🌞🌞🌞🌞🌞🌞🌞 !!

(Contact Sharon Bakay about volunteering!)

# Happy Mardi Gras - February 17

We still have some committee posts that need to be filled. If you have no committee post, something is missing. Ideally, each of us can share the load of more than one committee. So look close:

A co-chair is still needed for Habitat for Humanity Committee. Please

contact: Jo Ann Pugh, [joannpugh@hotmail.com](mailto:joannpugh@hotmail.com), 233-6004.

Also, School Garden Initiative still needs more volunteers to help teach gardening to elementary, middle, high school or special needs students.

Contact: Sherlyn Larrison, [sbellar@gmail.com](mailto:sbellar@gmail.com), 856-6662.

## Have you recorded your January Hours?

If we all get in a good habit early, we will be in better position to enjoy the year-end holidays. Did you attend the General Meeting on January 7, did you work on propagation or attend the 2nd Saturday class with Nick Simoneaux regarding lawn care? If you did, you should have recorded your hours for volunteering and/or education. Don't be caught short in 2015. Stick with the program and be happy.

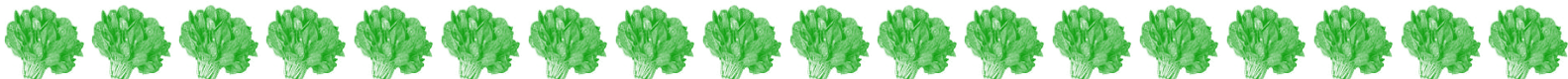

## What Plant Am I?

What Plant am I?

Although my fruit is not edible – as my name might suggest – I am a really nice evergreen shade tree. Some say I'm a native of the Upper Florida Keys, others think I originated in the West Indies. Zones 10B to 11 are my preferred habitat, because I may be killed if the thermometer dips below 25 degrees. When I'm young, I have a pyramidal shape, which turns into a dense full oval to rounded shape as I age. Sometimes, my crown will flatten out and I will begin to grow horizontally. I have lush dark bluish-green leaves, 2 to 4 inches long, which cluster at my branch tips, rather like Schefflera. Spines occasionally grow on my branches. I can grow to 40 to 50 feet tall with a spread of about 35 feet.

My greenish-yellow flowers are inconspicuous, and bloom from April to June. I grow best in full to partial sun in well-drained loam, clay or sandy soil. My aerosol salt tolerance and drought tolerance are high, but I may need to be watered until I become established. Seed propagation is difficult; layering has a better success rate. Some pruning may be necessary for me to develop a strong structure. I'm used as a shade tree along city streets, but should be planted ten or more feet away from sidewalks because of seed and leaf litter. I do well in large containers in atriums. One of my species is suitable as a Bonsai.

Because of the high tannins in my litter, I'm accused of staining sidewalks, patios, roofing; however, the staining is actually caused by a caterpillar. These caterpillars feed on my leaves and concentrate the tannins. When their frass (solid excretia) drops and gets wet, serious staining may result. The good news is that they're only active for about 6 weeks in early April to late June, and heavy infestations only occur about once every seven years.

Do you know what plant I am?

See page 6 for the answer.

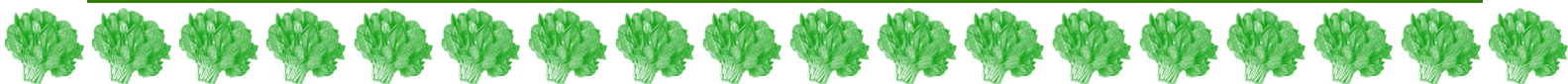



## Junior Master Gardener Report

Winter break is over and all the kids are back in school! Our gardens are resting after the fall harvest. This month we are focusing on spring planting using the spring planting guide and selecting vegetables for our spring gardens! Students are learning how deep to plant seeds and transplants, how many days to harvest and how to prepare the harvest, what continent the vegetable came from, what vitamins they provide and two interesting facts about the vegetable they are growing.



This year, Acadiana High will have their greenhouse up and running by February. We want all of our schools to plant seeds so they can transplant their plants into their spring gardens. The seedlings will be housed at Acadiana High School and when ready, taken back to the schools to transplant into their garden!

We are excited to announce that the students are planning their spring gardens with the emphasis on creating dishes for "My Plate Junior Iron Chef Competition" that will take place at the end of the school year. This is a new event for our program and more details will follow at the School Garden Initiative Social on Tuesday January 27, at 6 p.m. at Ira Nelson Center. (REMEMBER!?!)

All Master Gardeners are invited to the social! We are asking for master gardeners to bring a potluck dish to share! Come meet the teachers from the schools, as well as our sponsors! We will have a slide show picture presentation of all the school gardens, an informal session on what is working and what is not in the gardens, present information on a field trip to an edible school garden in New Orleans, introduce the culminating fundraiser/event of the "My Plate Junior Iron Chef competition and an update on the Junior Master Gardener garden and first two-day camp, April 6-7th! Wow!

# Come Enjoy the Fun!

Junior Master Gardener Camp is coming in April. The camp will be held April 6-7 for ages 9-11 and will cost \$70. Candy Bienvenu mapped out great activities that will expose the children to all aspects of gardening. They will initially take a tour of the ULL gardens and then get to experience the methods of vegetable and herb planting from seed. They will finish up with weed mapping and scarecrow building. Megan Montgomery has designed an overview of the children's garden where they will plant the produce that will be harvested during the summer JMG camp. The design includes a teepee, vertical beds for creating more room for production, bird houses, a worm house, and herbal and vegetable beds. The built beds will be painted by the children during the summer camp.

From Megan Montgomery  
CHILDREN's GARDEN PLAN

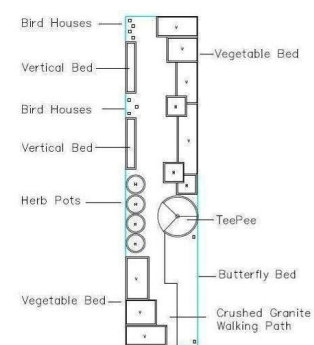

## ANNUAL BAMBOO WEEK

February 27-March 1

*American Bamboo Society  
Gulf Coast Chapter*

Activities will begin Friday evening with a social mixer followed by a meal and brief business meeting. Saturday morning we will meet at 8:30 at Avery Island to groom the magnificent Moso bamboo groves seldom seen by the public. At the end of the day, Moso bamboo poles will be available for those who took part in the activity. Saturday evening, we will tour the gardens of the Shadows on the Teche and then dine at Clemintines in New Iberia. Sunday morning at 9 we will gather on Avery Island for presentations on bamboo culture, artwork and crafts.

To register contact Judge or Elizabeth Edwards at

[judgeedwards@bellsouth.net](mailto:judgeedwards@bellsouth.net) or call 337-652-7469.

February Garden Stroll  
Committee Meeting

*There will be a Garden Stroll Committee Meeting on Thursday, February 26, at 10 a.m. at Linda Beyt's home. The address is 300 St. Christopher Street, Lafayette, 70506. Anyone interested in joining the Garden Stroll Committee is welcome!*



Special thanks to Kathy Van Ness who helped coordinate this stroll event. A second thanks to Ruth Moncus, Master Gardener Class-2014, for offering her gardens for a warm Louisiana winter stroll in December with Kay Bray, Dean Klopfer, Susan Chustz, Judy Corne, Christine Guillory, Maggie Chaisson, Ruth Moncus and center front, Babs Werner (to whom

**the 1st Garden Stroll  
will NOT be our last!**

# WHAT PLANT AM I? ANSWER:

Bucida buceras:  
Black olive, Oxhorn bucida



# BETWEEN THE ROWS

VEGETABLE GARDENING WITH  
MARY ANN ARMBRUSTER



Well, it's cold again, but, this is a great time to start seeds. We have discussed the benefits of starting your own plants from seed, so I won't repeat them here. Believe it or not, now is the time to start your tomatoes, peppers and eggplant from seed. If you don't have a greenhouse and, like me, don't have a lot of good window light, you might want to try a cold frame. A cold frame is like a mini-greenhouse, specifically intended for seed starting. You can build one easily. A simple frame, with an angle to the top allowing the cover to slope top to bottom, and an old window as the top works fine. The sides can be wood, cement blocks, or even hay bales as shown in the photos below. You can place the cold frame anywhere as long as you can access it easily - because you have to open it during those warm days that we have here from time to time. Leaving the cold frame closed on these days can cook your tiny seedlings, and we don't want to do that. I have collected some examples of simple cold frame constructions.

Place the cold frame in a handy place so that you can open it in the morning when necessary. It can be placed in a garden bed, on the lawn or even on a drive or other hard surface. The frame should be oriented so that the shortest depth faces south. This allows the most sun to the plants inside.

Now you have some choices to make. You can plant the seeds in the garden soil if the frame is set over a garden bed, but if you set the frame over lawn or hard surface, you can either fill the frame with good soil, or you can plant in pots or 6-packs and place those into the frame. Keep the seeds evenly moist and watch for temperature extremes. If low temperatures are predicted, cover the entire frame until it warms up again. If high temperatures are predicted (over 50) open the lid and prop it open, a little or a lot depending on how high it is supposed to get.

Now that you have a place to plant, which seeds to you want to plant this month? As I mentioned earlier, it's time to plant tomatoes, peppers and eggplants. You can also plant kohlrabi, but plant these inside, or in the cold frame, not out in the open yet. There are seeds you can plant outside in the open garden now though. All month you can plant beets, Swiss chard, Irish potatoes and radishes in the open garden. Through the middle of the month you can plant broccoli, Chinese cabbage, carrots and cauliflower, then starting mid-February you can plant beans and sweet corn. I know the list is not as long as usual, but this is the middle of the winter, after all.

There are few insects around this month, but the weeds are already starting. Try to keep those under control while they are tiny and while the ground is soft from the rains. It's so much easier that way, and yes, I know just how easy it is to not pull them, because they are so small and innocuous. But they grow so quickly! If you don't pull them NOW, they will be out of control and setting seed before you know it.

After you clear away a section of weeds you can sprinkle that area with corn gluten meal, an organic pre-emergence herbicide. Corn gluten meal stops seeds from germinating for about six weeks, then breaks down into a nitrogen fertilizer to feed the transplants that you will put in later. It's available in a couple of name brand products, like Preen, but that's the expensive way. If you go online you can find it as the generic 'corn gluten meal' for a lot less. I found it at the big box stores in liquid, ready to spray formulations and the more normal granular formula. Use five pounds for 250 square feet or follow label directions.

I know this isn't as much to do as most months, but it is the middle of winter after all. In other places we would still be a month or two away from planting anything. This is the time of year most gardeners are browsing through catalogs and dreaming – because that is all they can do. So consider yourselves lucky, and

Until next time,  
Good Gardening.  
MaryAnn Armbruster





# LPMGA Calendar February 2015

February 1: Black History Month !!!

Feb 2nd: Call Linda Beyt to reserve spot at Coyote Blues!

Feb 4th: General Meeting, South Regional Library, 6 pm followed by Informal Social

Feb 5th: "In the Garden" first run at AOC, broadcast on channels LUS and Cox

Jan 12th: Board Meeting, Ira Nelson Horticulture Center, 1 p.m.

Feb 14th: Valentines Day

Feb 17th: Happy Mardi Gras

Feb 26th: Garden Stroll Committee Meeting at Linda's, 10 a.m., pg 6

Feb 26th: Home Task Force meeting at Babette's house, 9:15 a.m., pg 1

Feb 27th:-Mar 1st: Bamboo Weekend/American Bamboo Society-Gulf Chapter, pg 6



*Gardener's Gazette* is issued to all members of the Lafayette Parish Master Gardeners' Program. All members are encouraged to submit news, educational features, and photographs. The deadline for all submissions is the 24th of each month for publication in the next month's issue unless otherwise noted.

Please send newsletter items to:

Theresa Rohloff [thescottherald@aol.com](mailto:thescottherald@aol.com) Please include:

"MG NEWSLETTER" in your subject bar.

The Master Gardener program is a division of the Louisiana Cooperative Extension Agency and can be contacted at:

1010 Lafayette Street/Suite 325,

Lafayette, Louisiana 70501

Telephone (337) 291-7090

fax (337) 291-7099

The Web site is [www.lsuagcenter.com](http://www.lsuagcenter.com)

The Louisiana cooperative extension provides equal opportunities in programs and employment. Louisiana State University and A&M College, Louisiana Governing Bodies, Southern University, and the United States Department of Agriculture Cooperating

A State Partner in the Cooperative Extension System

It is the policy of the Louisiana Cooperative Extension Service that no person shall be subjected to discrimination on the grounds of race, color, national origin, gender, religion, age, or disability.

If you have a disability which requires special assistance for your participation in our meetings, please call 337-291-7090

Please note: All meeting and event dates, times, and locations are subject to change.

  
**Gearing up for  
Mardi Gras!**

**Happy Valentine's  
Day !!!!!!**  
